

Steel-Flex® Marker Post

There are two types of marker posts approved in New Zealand under M14 requirements. They are PVC and Steel-Flex® Marker Posts. Steel-Flex® is a premium product with very high impact and corrosion resistance so it performs extremely well in high impact and coastal areas. The patented design and exclusive ArmorGalv® thermal diffusion coating enables the product to outlast comparable products for road edge delineation and utility marking.

* **NZTA M14 Compliant**

* **Superior Performance**

* **Guaranteed for up to 10 years**



**The Steel-Flex®
Marker Post is
proven to return
to vertical after
1500 impacts!**



Depth
Marker

Dual
Retention
Bars

Features & Benefits

- Complies to NZTA – M14 & AS/NZS 1906.1:2017
- 10 year Manufacturer Warranty
- Capable of withstanding repeated impacts
- Significantly reduces ongoing maintenance costs
- Outstanding performance over plastic with a thermal resistance from -30°C to +80°C
- Pre-coated with ArmorGalv® so will not rust
- Powder-coated white with a high gloss finish and Class 1A reflective sheeting for maximum visibility both day and night
- Dual retention bars to prevent dislodgement on impact and unlawful removal
- Depth marker to indicate recommended install depth

Why Use Steel-Flex® Marker Posts?

Steel-Flex® Marker Posts have superior performance properties vs a standard PVC Post. By installing a long-lasting post you will save money in the long run as it reduces associated costs involved in replacement including downtime spent travelling to site.

They are easier to install compared to a PVC post, are designed to withstand multiple impacts, tested to return to vertical after 1500 impacts and backed by a 10 year Manufacturer Warranty.

Key Features



Easy Installation

Steel-Flex® Marker Posts can quickly and easily be installed by one person using the 'low impact' universal manual driver.

The ergonomic design with special spring-loaded handles reduce the impact and injury risk.



Highly Durable

Steel-Flex® Marker Posts feature a concave profile with vertical ribs.

The posts are capable of withstanding repeated impacts and are backed by a 10 year Manufacturer Warranty.

RTL Product:

Steel-Flex Marker Post
(C/w red band and white delineator)

Steel-Flex Rammer

Stock codes:

MP04 SF14D
(plain also available)

MP04 SFRAM

Placing an Order:

For ease of ordering, please mention the Steel-Flex® Marker Posts and reference stock codes above.

Steel-Flex® Marker Posts: Providing a continuous line of road edge delineation

Installation Instructions

Before installing your post into the ground, always remember to survey the area for any underground obstructions (i.e. gas pipes) first. **Always face the traffic during installation and ensure that the Steel-Flex® retention bars are pointing towards you.** If, during installation, the post meets stubborn resistance, STOP. You may have hit a pipe or rock. Remove the post and check the ground before proceeding.

Installing Steel-Flex® using the Universal Post Driver - Visual Guide

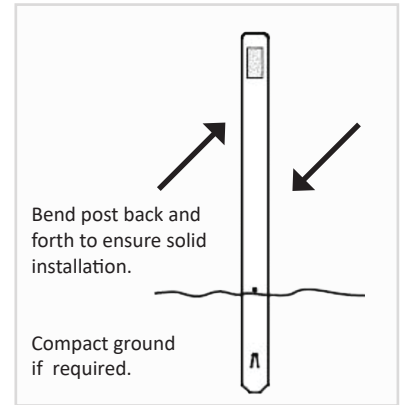
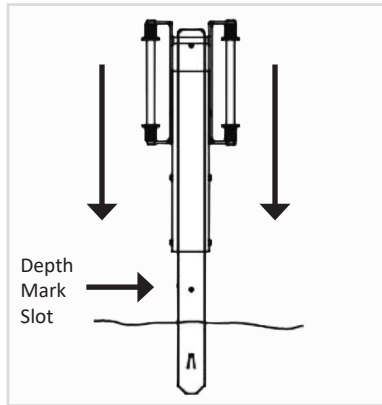
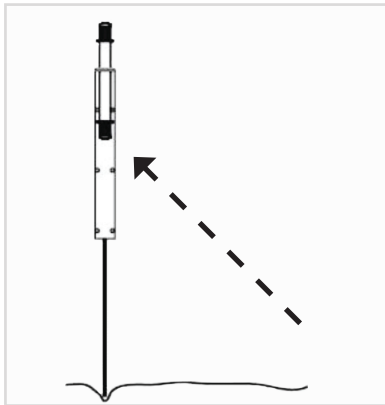
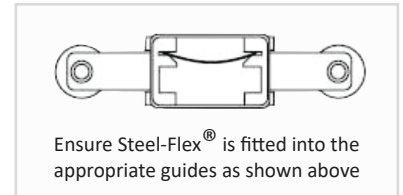
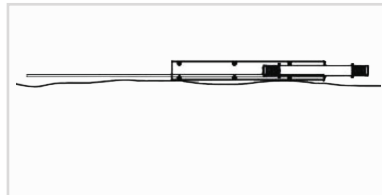
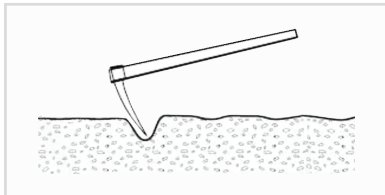

Installing Steel-Flex® using the Universal Post Driver - Step by Step Guide

- Step One:** To maximize the life of the post, chip out a small section of the road edge surface (approx. 100mm deep x 300mm wide) using a mattock or spade.
- Step Two:** Lay the post and ergonomic driver on the ground and slide the post into the guides of the driver.
- Step Three:** Lift the driver and post carefully to vertical ensuring that the post driving point is located in the middle of the dugout section.
- Step Four:** Drive the post into the ground letting the weight of the driver do the work – not your back. Only short light strokes are required. Excess force may cause the post to flex. Continue driving until the depth mark slot is at ground level.
- Note:** *It is important that the post is driven in this far for it to function properly and be firmly anchored into the ground.*
- Step Five:** Keeping your arms slightly extended and your head and face away from the driver, carefully remove the driver from the post.
- Step Six:** Check for a secure installation and satisfactory post function by slowly bending the post back and forth. If the post is loose, the ground may be too soft in which case the ground surrounding the post should be compacted.
- Step Seven:** To ensure that the post is installed to the specified height, check that the Depth Mark Slot is at ground level.